



Replacement of 92 and 93 Series 28,32 and 36 Function Transmitters



92 3 28TX
Transmitter

complete with
Lo-Cover and
Lanyard

WHEN POWER IS CONNECTED TO A RECEIVER



A CODING WINDOW IS MADE AVAILABLE FOR 20 SECONDS

AN ACTIVE CODING WINDOW IS INDICATED BY THE RECEIVER FAULT LED FLASHING

TRANSMITTER REGISTRATION CAN ONLY TAKE PLACE DURING THIS TIME

MAIN RECEIVER

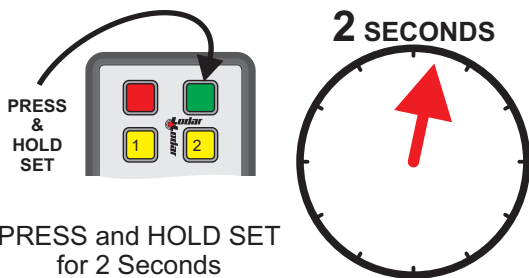

CONNECT POWER to MAIN receiver ONLY THE FAULT LED COMMENCES TO FLASH DO NOT RELEASE SET

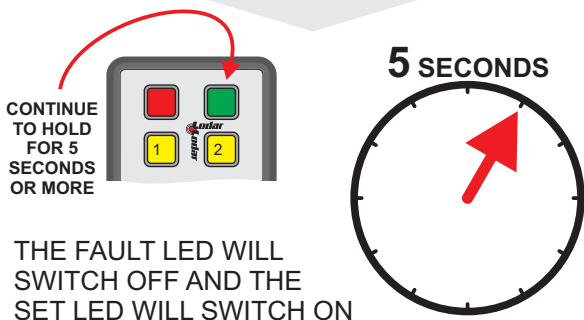

THE TRANSMITTER IS NOW REGISTERED TO THE MAIN RECEIVER

SHIFT RECEIVER

CONNECT POWER to SHIFT receiver ONLY THE FAULT LED COMMENCES TO FLASH

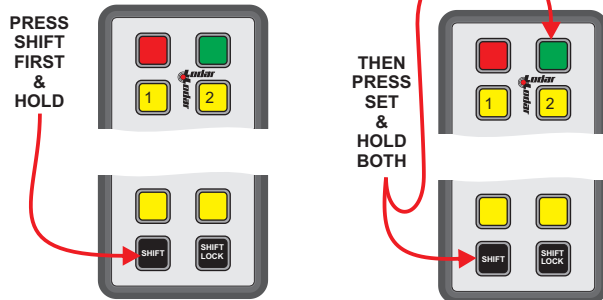
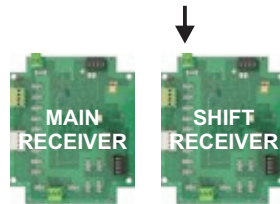

HOLD BOTH "SHIFT & SET" FOR 5 SECONDS

THE FAULT LED WILL SWITCH OFF AND THE SET LED WILL SWITCH ON

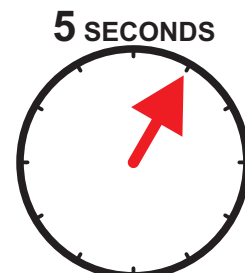

THE TRANSMITTER IS NOW REGISTERED TO THE SHIFT RECEIVER

TEST

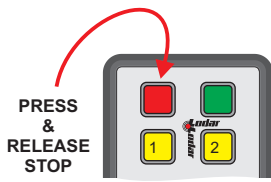

CONNECT POWER to both receivers

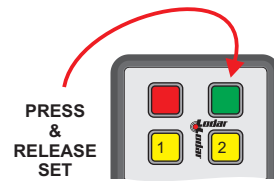
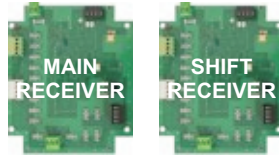

The SET LED's on both receivers should now be ON

YOU HAVE SUCCESSFULLY SET UP YOUR SYSTEM

We, Skidmore 4wd Ltd., 60 Sandwell St., Walsall. WS1 3EB England.

Declare under our sole responsibility that the product:

Product Details Name - Lodar
 Series - 92 0 04

To which this declaration relates is in conformity with the essential requirements and other relevant requirements, and is compliant with the standards and/or other documents, of the following directives :

| | | |
|----------------|---|---------------------|
| EN 301 489-3 | (1999/5/EC) | |
| R&TTE | Low Voltage Directive 300.683 | |
| Safety | BS EN 954-1 to Category 3. | |
| | BS EN 60204-1 | |
| EMC | 89/336/EEC | ETSI 300-220 v1.1.1 |
| Automotive EMC | Approval Granted - e11*72/245*95/54*3087*00 | |
| FCC | Approval Granted | |
| Spectrum | 433.92 MHz F1D (EUROPE) | |
| | 418.0 MHz F1D (USA) | CE |

Please note that this certificate only covers Lodar and not the installation

| | | |
|--------------------|----------|----------|
| Martin Skidmore | Position | Date |
| <i>M. Skidmore</i> | CEO | Jan 2009 |

F.C.C. PART 15 INTENTIONAL RADIATOR MANUAL STATEMENT RADIO FREQUENCY INTERFERENCE STATEMENT

Note, this equipment has been tested and found to comply with the limits for an intentional radiator, pursuant to Part 15, subpart C of the F.C.C. Rules. This equipment generates uses and can radiate radio frequency energy. If not installed and used in accordance with the instructions, it may cause interference to radio communications.

The limits are designed to provide reasonable protection against such interference in a residential situation. However there is no guarantee that interference will not occur in a particular installation. If this equipment does cause interference to radio or television reception, which can be determined by turning the equipment on and off, the user is encouraged to try to correct the interference by one or more of the following measures:

- Reorient or relocate the receiving antenna of the affected radio or television
- Increase the separation between the equipment and the affected receiver.
- Connect the equipment and the affected receiver to power outlets on separate circuits.
- Consult the dealer or experienced radio/TV technician for help.

MODIFICATIONS

Changes or modifications not expressly approved by Skidmore 4wd Ltd. could void the users authority to operate the equipment

FM Series

System Part No. Transmitter Part No.

- | | | | |
|------------------------------------|--------------------------------------|------------------------------------|--------------------------------------|
| 92 3 28-3 <input type="checkbox"/> | 92 3 28TX-3 <input type="checkbox"/> | 93 3 28-x <input type="checkbox"/> | 93 3 28TX-x <input type="checkbox"/> |
| 92 3 32-3 <input type="checkbox"/> | 92 3 36TX-3 <input type="checkbox"/> | 93 3 32-x <input type="checkbox"/> | 93 3 36TX-x <input type="checkbox"/> |
| 92 3 36-3 <input type="checkbox"/> | 92 3 36TX-3 <input type="checkbox"/> | 93 3 36-x <input type="checkbox"/> | 93 3 36TX-x <input type="checkbox"/> |
| 92 3 28-8 <input type="checkbox"/> | 92 3 28TX-8 <input type="checkbox"/> | | |
| 92 3 32-8 <input type="checkbox"/> | 92 3 36TX-8 <input type="checkbox"/> | | |
| 92 3 36-8 <input type="checkbox"/> | 92 3 36TX-8 <input type="checkbox"/> | | |

Date purchased

Serial No.